

Rev.	Date	Drawn By
A	20100425	Changhui Zhang

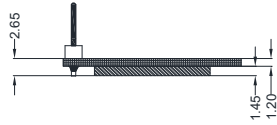
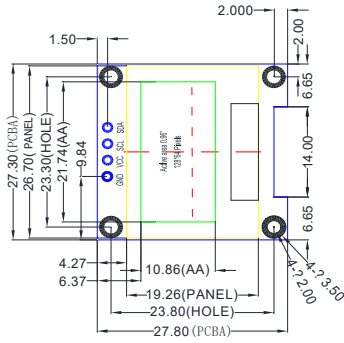

Pin Descriptions	
Pin	Symbol
1	GND
2	VCC
3	SCL
4	SDA

- NOTES:
1. DISPLAY TYPE: 0.96" OLED
 2. VIEWING DIRECTION: ALL
 3. POLARIZER MODE: TRANSMISSIVE/NORMALLY BLACK
 4. DRIVER IC: SSD1306
 5. Resolution: 128x64
 6. INTERFACE: IIC
 7. VOLTAGE: 3.3V
 8. OPERATING TEMP: -40° C ~ 70° C

Customer Approval		Radiant-way Technology Inc.	
Customer Name	RAY	Product Name	0.96" OLED Display Module
Customer Part No.	042	Part Number	DR01-Norm096
Customer Qty	1000	Drawn	E.E.
Customer Date	20100425	Checked	
Customer E-mail		Drawn	
Customer Address		Checked	
Customer Phone		Drawn	
Customer Fax		Checked	
Customer Website		Drawn	
Customer Email		Checked	
Customer Name		Drawn	
Customer Address		Checked	
Customer Phone		Drawn	
Customer Fax		Checked	
Customer Website		Drawn	
Customer Email		Checked	
Customer Name		Drawn	
Customer Address		Checked	
Customer Phone		Drawn	
Customer Fax		Checked	
Customer Website		Drawn	
Customer Email		Checked	